



澳門大學  
UNIVERSIDADE DE MACAU  
UNIVERSITY OF MACAU

# Postgraduate House (PGH) S1 Hostel Handbook



Student Affairs Office (SAO) - Student Resources and Services Section (SRS)

# Table of Contents

Transportation..... 1

Procedures of move-in and move-out ..... 8

Cards..... 9

Things to be prepared before moving-in ..... 9

Facilities..... 10

Services..... 12

Important points to note..... 12

Safety issue..... 12

General rules ..... 12

Contact points ..... 13

Appendix..... 14



# Transportation

Private vehicles are allowed to enter the University of Macau (UM) campus and travel only in the designated area. Public transportation arrangement for entering the campus is as follows:

## 1. Taxi

Taxis are permitted to enter the campus and the taxi fares are based on a flag-down fare and the distance travelled.

## 2. Public Bus

There are THREE public buses connecting the campus and the Macau Peninsula / the Taipa.

### a) Route number: 37U

**Operation hours:** Monday – Friday, from 6:30 am – 12:14 am  
Saturday – Sunday, from 6:30 am – 12:15 am

**Bus frequency:** Every 10 – 15 minutes

**Bus fare:** MOP2.8

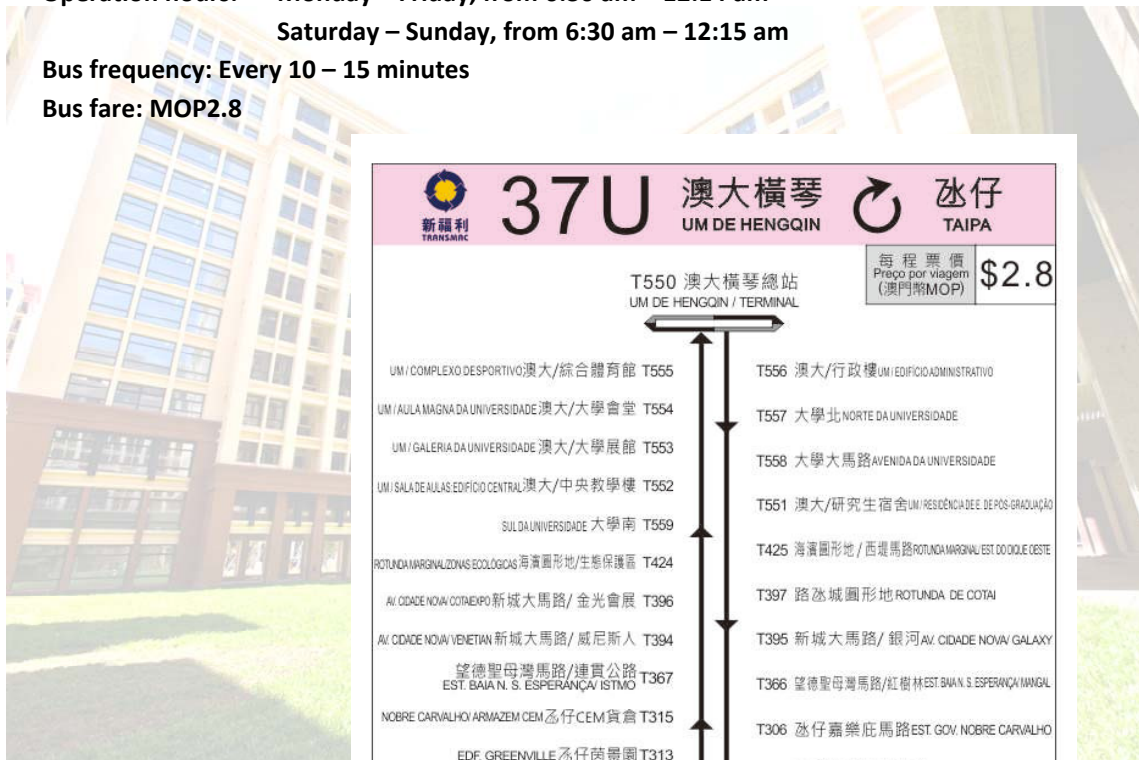



# 37U

澳大橫琴  
UM DE HENGQIN



# 氹仔

TAIPA

每程票價  
Preço por viagem  
(澳門幣MOP)

\$2.8

T550 澳大橫琴總站  
UM DE HENGQIN / TERMINAL



UM / COMPLEXO DESPORTIVO 澳大/綜合體育館 T555 UM / AULA MAGNA DA UNIVERSIDADE 澳大/大學會堂 T554 UM / GALERIA DA UNIVERSIDADE 澳大/大學展館 T553 UM / SALA DE AULAS EDIFÍCIO CENTRAL 澳大/中央教學樓 T552 SUL DA UNIVERSIDADE 大學南 T559 ROTUNDA MARGINAL ZONAS ECOLÓGICAS 海濱園形地/生態保護區 T424 AV. CIDADE NOVA / COTAI 新城大馬路/金光會展 T396 AV. CIDADE NOVA / VENETIAN 新城大馬路/威尼斯人 T394 望德聖母灣馬路/連貫公路 EST. BAIAN S. ESPERANÇA / ISTMO T367 NOBRE CARVALHO ARMAZEM CEM 氹仔 CEM 貨倉 T315 EDF. GREENVILLE 氹仔茵景園 T313 AV. DR. SUN YAT SEN SAM KÁ 孫逸仙馬路/三家村 T310 EDF. CHUN LUEN 泉亮花園 T309 AV. DR. SUN YAT SEN R. LAGOS 氹仔大中華廣場 T304 NEW CENTURY HOTEL 新世紀酒店 T307	T556 澳大/行政樓 UM / EDIFÍCIO ADMINISTRATIVO T557 大學北 NORTE DA UNIVERSIDADE T558 大學大馬路 AVENIDA DA UNIVERSIDADE T551 澳大/研究生宿舍 UM / RESIDÊNCIA DE E. DE PÓS-GRADUAÇÃO T425 海濱園形地 / 西堤馬路 ROTUNDA MARGINAL EST. DO OLEO OESTE T397 路氹城園形地 ROTUNDA DE COTAI T395 新城大馬路/銀河 AV. CIDADE NOVA / GALAXY T366 望德聖母灣馬路/紅樹林 EST. BAIAN S. ESPERANÇA / MANGL. T306 氹仔嘉樂庇馬路 EST. GOV. NOBRE CARVALHO T314 亞利雅架前地/泉悅 LARGO JÚNIOR ARRAGA EDF. CHUN YUET T408 湖畔大廈 EDIFÍCIO DO LAGO T341 徐日昇黃公馬路 AV. PADRE T. PEREIRA T428 聚龍明珠/榮苑 TJOI LONG SEA VIEW BLOCO 1
------------------------------------------------------------------------------------------------------------------------------------------------------------------------------------------------------------------------------------------------------------------------------------------------------------------------------------------------------------------------------------------------------------------------------------------------------------------------------------------------------------------------------------------------------------------------------------------------------------------------------------------------------------------	------------------------------------------------------------------------------------------------------------------------------------------------------------------------------------------------------------------------------------------------------------------------------------------------------------------------------------------------------------------------------------------------------------------------------------------------------------------------------------------------------------------------------------------------------------------------------



循環線  
PERCURSO CIRCULAR

總站  
TERMINAL

首班車 PRIMEIRO VEÍCULO  
 尾班車 ÚLTIMO VEÍCULO

星期一至星期五 (公眾假期除外) 2.ª a 6.ª feira (excepto feriados públicos)	星期六 (公眾假期除外) Sábados (excepto feriados públicos)	星期日及公眾假期 Domingos e feriados públicos
06:30-09:54 12分/15分 09:54-16:54 15分/10分 16:54-00:14	06:30-00:15 15分/10分	06:30-00:15 15分/10分

 澳門新福利公共汽車有限公司  
TRANSMAC TRANSPORTES URBANOS DE MACAU, S.A. (L.)

查詢熱線 HOTLINE : 2827-1122

1

Updated on 08/06/2015

- **Method of transferring to 37U from other public bus routes**

From	Bus Route	Transferring Bus Stop
Barrier Gate (Gong Bei Border)	25X	Av. Dr. Sun Yat Sen / Rua De Lagos
	30	Rotunda Dr. Carlos A.C.P. D'Assumpcao
COTAI Frontier Post (Lotus Border)	21A, 25, 26A, 50	Av. Dr. Sun Yat Sen / CTM (Taipa CTM) Cross the pedestrian bridge to Bus Stop of "Av. Dr. Sun Yat Sen / Rua De Lagos"
Macau International Airport	MT2	Av. Dr. Sun Yat Sen / CTM (Taipa CTM) Cross the pedestrian bridge to Bus Stop of "Av. Dr. Sun Yat Sen / Rua De Lagos"
	N2	Rotunda Dr. Carlos A.C.P. D'Assumpcao
Macau Maritime Ferry Terminal	28A	Av. Dr. Sun Yat Sen / Rua De Lagos
Taipa Temporary Ferry Terminal	MT2	Av. Dr. Sun Yat Sen / CTM (Taipa CTM) Cross the pedestrian bridge to Bus Stop of "Av. Dr. Sun Yat Sen / Rua De Lagos"
	N2	Rotunda Dr. Carlos A.C.P. D'Assumpcao





b) Route number: MT3U

Operation hours: Monday – Saturday, from 6:30 am – 12:06 am  
Sunday, from 6:30 am – 12:10 am

Bus frequency: Every 12 – 20 minutes

Bus fare: MOP4.2 – From UM Terminal to Macau Peninsula

MOP2.8 – From any stops at UM Campus to UM Terminal



# MT3U

澳大橫琴

UM DE HENGQIN



黑沙環

AREIA PRETA

車資以本站對應顏色票價計算  
(每程票價按澳門幣計算)  
Preço corresponde ao identificado  
pelo cor tarifária desta paragem.

**T550 澳大橫琴總站**  
UM DE HENGQIN / TERMINAL



	 循環線 PERCURSO CIRCULAR	 總站 TERMINAL	<div style="display: flex; justify-content: space-between;"> <span style="color: blue;">■</span> 首班車 PRIMEIRO VEÍCULO</div> <div style="display: flex; justify-content: space-between;"> <span style="color: pink;">■</span> 尾班車 ÚLTIMO VEÍCULO </div>
附 錄 A 時 間 表	<b>星期一至星期五 (公眾假期除外)</b> 2.ª a 6.ª feira (excepto feriados públicos)		
	06:30-09:30 12分鐘 mins	06:30-09:30 12分鐘 mins	06:30-00:10 20分鐘 mins
	09:30-15:50 20分鐘 mins	09:30-15:50 20分鐘 mins	
	15:50-20:26 12分鐘 mins	15:50-20:26 12分鐘 mins	
	<b>星期六 (公眾假期除外)</b> Sábados (excepto feriados públicos)		
	06:30-09:30 12分鐘 mins	06:30-09:30 12分鐘 mins	06:30-00:10 20分鐘 mins
	09:30-15:50 20分鐘 mins	09:30-15:50 20分鐘 mins	
	15:50-20:26 12分鐘 mins	15:50-20:26 12分鐘 mins	
	<b>星期日及公眾假期</b> Domingos e feriados públicos		
	06:30-00:10 20分鐘 mins	06:30-00:10 20分鐘 mins	



澳門公共汽車有限公司

Sociedade de Transportes Colectivos de Macau, S.A.R.L.

**查詢熱線 HOTLINE : 2885-0060**

2014-06



c) Route number: 71

Operation hours: Monday – Sunday, from 6:30 am – 12:00 am

Bus frequency: Every 8 – 12 minutes

Bus fare: MOP4.2 – From UM Terminal to Macau Peninsula

MOP2.8 – From any stops at UM Campus to UM Terminal

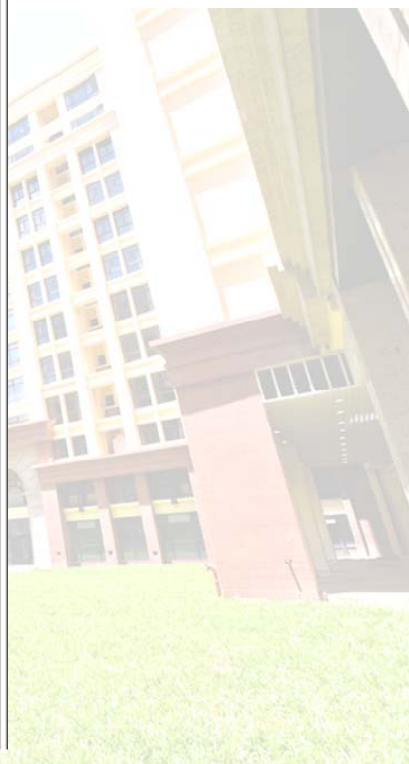
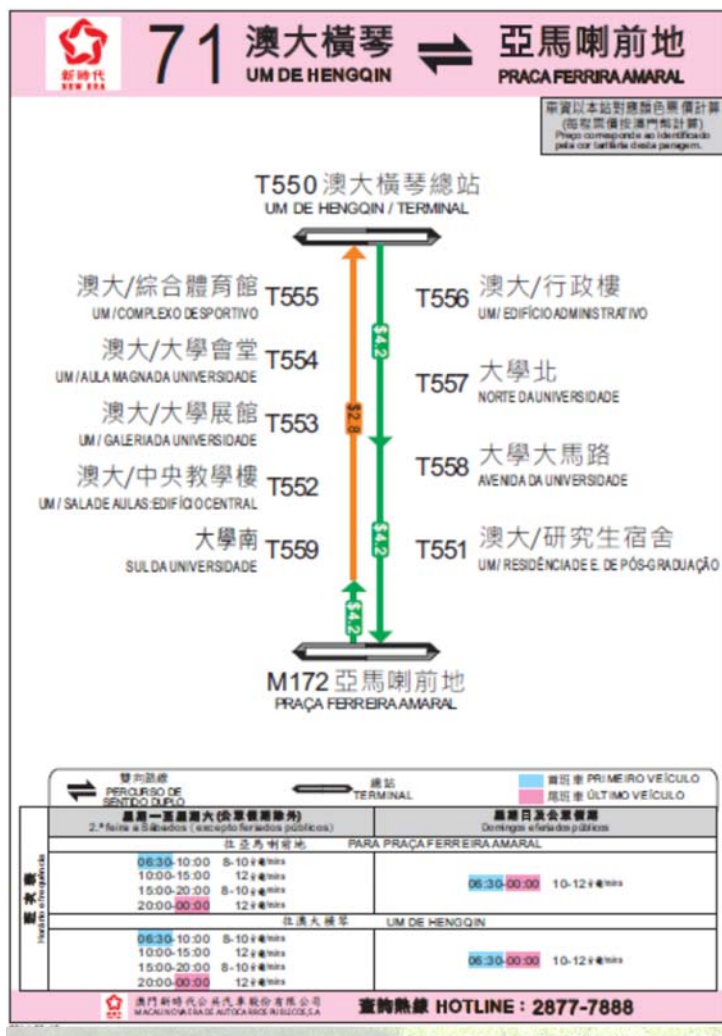

- Method of transferring to MT3U and 71 from other public bus routes

From	Bus Route	Transferring Bus Stop
Barrier Gate (Gong Bei Border)	3, 3A, 3X, 10, 10B, 10X, 25X, 30	Praca Ferreira Amaral
Macau Maritime Ferry Terminal	10A, 28A	Praca Ferreira Amaral

d) Route number: 71X

Operation hours: Monday – Friday (except Public Holidays),  
from 7:30 am – 10:00 am; 5:00 pm – 8:00pm

Bus frequency: Every 15 minutes

Bus fare: MOP2.8 – From any stops at UM Campus to UM Terminal

# 71X

澳門大學  
UNIVERSIDADE DE MACAU

氹仔  
TAIPA

每程票價  
Preço por viagem  
(澳門幣MOP)

\$2.8

T550 澳門大學總站  
UNIVERSIDADE DE MACAU/ TERMINAL

澳大/綜合體育館 T555  
UM / COMPLEXO DESPORTIVO

澳大/大學會堂 T554  
UM / AULA MAGNADA UNIVERSIDADE

澳大/大學展館 T553  
UM / GALERIA DA UNIVERSIDADE

澳大/中央教學樓 T552  
UM / SALA DE AULAS-EDIFÍCIO CENTRAL

大學南 T559  
SUL DA UNIVERSIDADE

奧林匹克大馬路 T368  
AVENIDA OLÍMPICA

T556 澳大/行政樓  
UM/ EDIFÍCIO ADMINISTRATIVO

T557 大學北  
NORTE DA UNIVERSIDADE

T558 大學大馬路  
AVENIDA DA UNIVERSIDADE

T551 澳大/研究生宿舍  
UM/ RESIDÊNCIA E. DE PÓS-GRADUAÇÃO

T309 泉亮花園  
EDF. CHUN LUEN

圓環線  
PERCORSO CIRCULAR

總站  
TERMINAL

首班車 PRIMEIRO VEÍCULO

尾班車 ÚLTIMO VEÍCULO

星期一至星期五 (除公眾假期外) 2.ª a 6.ª Feira (exceto feriados públicos)		
07:30	10:00	15 分鐘
17:00	20:00	15 分鐘

星期六、星期日及公眾假期停駛  
SERVIÇO SUSPENSO NOS SÁBADOS, DOMINGOS E FERIADOS

澳門新時代公共汽車股份有限公司  
MACAU NOVA ERA DE AUTOVIAS PUBLICAS

查詢熱線 HOTLINE : 2877-7888

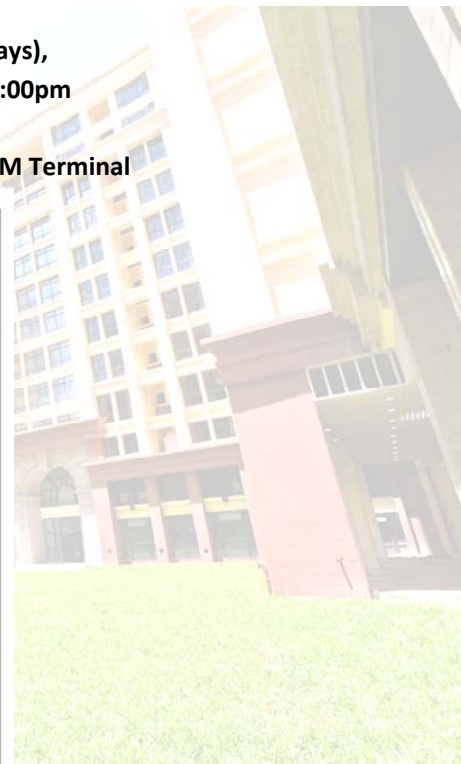

#### 4. Midnight Shuttles

Midnight shuttles provide connection between the campus and the Taipa downtown. The operation hours are every day from 12 am – 6:40 am. Please present your Room Key Card when boarding, the service runs on “first come, first served” basis while NO standing is allowed. In case you have encountered any problem with the overnight inter-campus shuttle bus, please call our Security Team at 8822 4126.

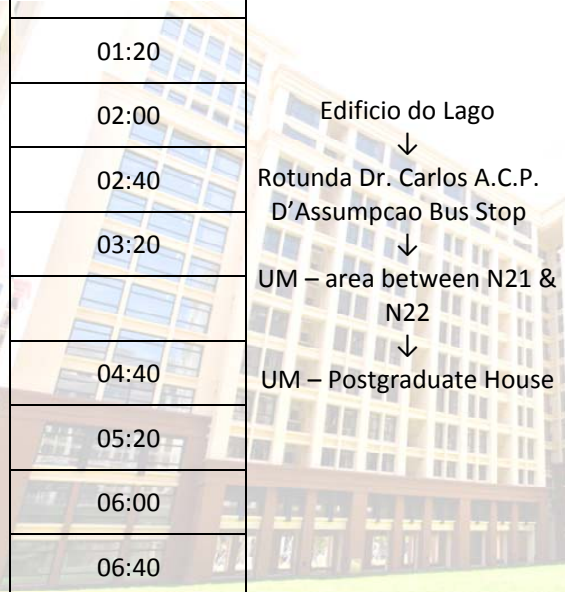
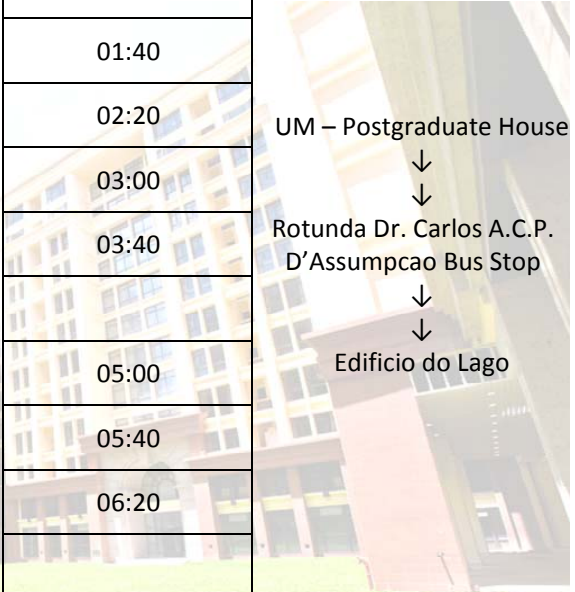
From Edificio do Lago		From UM Postgraduate House	
Departure	Route	Departure	Route
00:00	 Edificio do Lago ↓ Rotunda Dr. Carlos A.C.P. D'Assumpcao Bus Stop ↓ UM – area between N21 & N22 ↓ UM – Postgraduate House	00:20	 UM – Postgraduate House ↓ Rotunda Dr. Carlos A.C.P. D'Assumpcao Bus Stop ↓ Edificio do Lago
00:40		01:00	
01:20		01:40	
02:00		02:20	
02:40		03:00	
03:20		03:40	
04:40		05:00	
05:20		05:40	
06:00		06:20	
06:40			

#### 5. Campus Loop Service

In view that the campus covers a total area of 1 km<sup>2</sup> and it is consisted of more than 80 buildings, our staff, students and guests can make use of the campus loop service, which operates from Mondays to Sundays, to travel between different buildings on campus. Please present your Room Key Card when boarding, the service runs on “first come, first served” basis while NO standing is allowed.

Please refer to the website of the Security and Transport Section (STS) for the campus loop service schedule and route, as well as campus transportation updates [http://www.umac.mo/sts/svc\\_transportation.html](http://www.umac.mo/sts/svc_transportation.html)

In case of any inconsistency about the transportation information between this handbook and the website of STS, the website of STS shall prevail.





# Procedures of move-in and move-out

- **Move-in**

1. Bring the following documents to the reception at **PGH – S1, G/F, Room G005** #.
  - A copy of your personal identification card / passport
  - The accommodation confirmation email sent by SRS
2. Present the aforementioned documents to the receptionist.
3. Fill in the required information and sign in the Postgraduate House -S1 Hostel Registration Form\*.
4. Settle your accommodation fee (if any) upon move-in. Kindly note that the accommodation fee is non-refundable.
5. Receptionist will provide the “Room Key Card” and “Facility Access Card” to you.

# Location is shown on the “PGH Facilities Map”.

\* For the resident whose stay period is 14 days or beyond, please return the registration form to the reception at **PGH – S1, G/F, Room G005**# within 3 days of your move-in day. If there is no receipt, it is considered that your room equipment is in good condition and you should bear the responsibility of any damage to the equipment.

- **Move-out**

1. Please approach to the reception at **PGH – S1, G/F, Room G005**# for processing the move-out procedure.
2. All move-out procedure is required to be finished on or before 12 noon at the move-out day.
3. Any late move-out or extension of stay will need to be requested to SRS Student Housing / S1 Reception at least 1 working day prior to the originally proposed move-out day. Otherwise, exceeding move-out times may result in a special charge of 1 night accommodation being applied to the bill. Any request is subject to approval from SRS Student Housing and room availability.
4. Clean up your room before moving out.
5. No personal belonging or garbage should be left in your room. Otherwise, cleaning fee and garbage removal fee will be charged.
6. Please settle the payable fee (if any) of any damage or lost for the in-room equipment. Please note that all the payable fees are non-refundable.
7. Return your “Room Key Card” and “Facility Access Card” to the receptionist.

# Location is shown on the “PGH Facilities Map”.

## Cards

Bear in mind to bring your “Room Key Card” and “Facility Access Card” with you at all time, and not to lose or damage those cards. Replacement for the “Room Key Card” incurs a fee of MOP20, while it is MOP50 for the “Facility Access Card”. If you forget to bring your “Room Key Card” or are locked out of your room, please contact the reception to help you opening your room door. A fee of MOP10 will be charged.

In addition, if you would like to invite your guest to visit PGH facilities and your own room, you or your guests must submit an application to the reception for a Visitor Pass of PGH. The visiting hours are in accordance with the non-quiet hours of PGH, which are from 7am to 10pm. The applying visitors must return the Visitor Pass to the reception before leaving PGH. No visitor is permitted to stay in PGH after visiting hours.



# Things to be prepared before moving-in

- **Documents needed for move-in**

Please prepare the following documents for the move-in procedure.

- A copy of your personal identification card / passport
- The accommodation confirmation email sent by SRS

- **Personal necessities**

Rooms in S1 Hostel are fully furnished, internet-connected, air-conditioned and ensuite bathroom. Meanwhile, PGH is fully committed to protecting our shared environment, so green practices are implemented, amenities like shower gel, shampoo, tooth brush, tooth paste are required to be obtained in the reception if necessary.

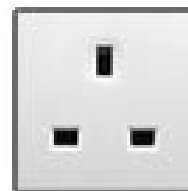

- **Electrical adapter**

The voltage in Macau is 220 volts and the type of socket in the PGH contains three holes in rectangular shape, forming an isosceles triangle. It is suggested to bring your own electrical adapters.

- **Network cable**

If you want to access internet or get WI-FI access in your room, please approach to the reception for borrowing the internet cable, the user manual, or getting the WI-FI password. Please note that in some of the rooms, the internet connection sockets are hidden behind the furniture.



- **Telephone**

There is no telephone provided in the room. Please prepare your mobile phone for contact, if necessary. Major Macao mobile networks are installed in the new campus. If you are using a SIM card which is from the local mobile service provider, please be reminded to choose "manual" when selecting a mobile network mode so as to avoid roaming since the campus is close to Mainland China.

## Facilities

Facilities	Location #	Opening hours	Remarks
<b>Postgraduate House</b>			
Laundry	PGH – S1 G/F	24 hours	Washing machines are provided to PGH residents to wash and dry the clothes. Please note that washing powder is NOT provided.
Drying Rooms	Each floor of PGH – S1, except G/F	24 hours	---
Pantries	Each floor of PGH – S1	24 hours	Fridges, microwave oven and water dispensers are available in the pantries.
Fitness Room, Badminton, and Table Tennis Court	PGH – S3, G/F, G021	Mon – Sun 7 am – 11 pm	Free of charge
Study Room Television Room	PGH – S2, G/F	24 hours	---
<b>University of Macau Campus</b>			
Medical Center	Sports Complex N8 G/F, G002	Mon – Thu: 9 am – 1 pm, 2:30 pm – 5:45 pm Fri: 9 am – 1 pm, 2:30 pm – 5:30 pm Sat: 9 am – 1 pm	<b>Service:</b> Medical consultation Nursing and first aid Measurement of height and weight Blood pressure Body fat percentage <b>Tel:</b> 8822 4123
“Fortune Inn” Chinese Restaurant	Guest House N1, G/F	Mon – Sun 11 am – 3 pm 5:30 pm – 10:30 pm	---
Pacific Coffee	Wu Yee Sun Library E2 (North Wing), G/F	Mon – Sun 8 am – 10 pm	---
Canteen “Food Paradise”	Central Teaching Building E6, G/F	Mon – Sun 8:30 am – 8:30 pm	---
<b>University Mall</b> A mini shopping mall which consists of dining and retail outlets such as pharmacy, bank, laundry, supermarket, bakery, restaurant, book store, travel agency, etc.			
Pharmacy	University Mall S8, G/F, G015	Mon – Fri: 9 am – 9 pm, Sat – Sun: 9 am – 8 pm	---
Bank of China	University Mall S8, G/F, G012	Mon – Fri 10 am – 5:30 pm	---
Clean Living Laundry	University Mall S8, G/F, G011	Tue – Sun 10 am – 2 pm, 3 pm – 6 pm	It is chargeable. For the price, please refer to the laundry company.



Supermarket	University Mall S8, G/F, G001 & G003	Mon – Sun 8:30 am – 11 pm	Chargeable snacks, fruits, beverages and daily necessities are available in the Service Centre.
“Red Forest” Restaurant	University Mall S8, 1/F, 1009	Mon – Sun 8 am – 9 pm	---
“Padaria da Guia” Bakery	University Mall S8, G/F, G013	Mon – Sun 7 am – 11 pm	---
Azucar	University Mall S8, G/F, G014	Mon – Fri 12 pm – 9 pm Sat – Sun 12 pm – 7pm	Serves snacks, Chinese and Western desserts
“Old Macau” Restaurant	University Mall S8, 1/F, 1001	Mon – Sun 11 am – 10 pm	---

# Location is shown on the “PGH Facilities Map”.

There are some more campus dining and retail outlets which are not listed in the above table. For campus dining and retail outlets updates, please visit the website of the Campus Services Section (CS) [http://www.umac.mo/cs/U-Mall/Shopping%20Mall\\_E.html](http://www.umac.mo/cs/U-Mall/Shopping%20Mall_E.html)

In case of any inconsistency about the dining and retail outlets information between this handbook and the website of CS, the website of CS shall prevail.



## Services

- **Weekly towel and garbage handling service**

The handling service is carried on every Monday and Thursday.

- **Bi-weekly bathroom cleaning service**

The cleaning service is carried on a bi-weekly basis and the schedule will be posted on the notice board on each residential floor.

- **Repair and maintenance service**

Please approach to the reception at **PGH – S1, G/F, Room G005<sup>#</sup>** if your room needs any equipment maintenance.

# Location is shown on the “PGH Facilities Map”.

## Important points to note

- **Internet access**

You can access the Internet in your room by using internet cable (please bring your own internet) or WI-FI. Please note that in some of the rooms, the internet connection sockets are hidden behind the furniture.

- **Noise level**

The period from **10 pm – 7 am** is regarded as the quiet hours of PGH. You are expected to behave in a mature and responsible manner. Please do not create noise nuisance and disturb other residents.

- **Smoking**

Smoking is prohibited within the entire PGH complex except in specified smoking zones.

- **Alcohol**

Possession or drinking of alcohol in PGH is prohibited.

## Safety issue

- **Guest identification**

- For identification issue, you are required to use your **Facility Access Card** to open the gate when you are entering into PGH buildings. Please also notice that the security guards may also require you to present your PGH Room Key Card or identification document(s) at the lobby.

- **Fire safety**

An evacuation plan for emergency can be found behind your room door. Please read it carefully. In case of a fire, keep calm and escape from the building via the nearest exit.

- **Emergency**

In case of an emergency, **please first seek help from the security guard nearby or contact the Reception, contact number: 8822 2531 / 6353 1156**. The number of calling police, ambulance and fire station in Macau is **999**. Please also inform the security guard or reception after calling for emergency.

# Location will be shown on the “PGH Facilities Map”.

## General rules

The following behaviors are considered as disciplinary offences and **are prohibited** in PGH. They apply to all residents, temporary residents and visitors. For details, please refer to the Postgraduate House Resident Rules.

- a) Entering PGH with hazardous articles and substances, forbidden medicine or drugs;
- b) Bringing pets into or keeping pets in PGH;
- c) Bringing visitors into PGH during non-visiting hours or without prior approved application from the Reception/ Management Company/ SRS;
- d) Entering rooms of the opposite sex;
- e) Smoking in PGH, except in the specified smoking zones;
- f) Drinking or possession of alcohol or alcohol content beverages in PGH, except with prior written approval by the Vice Rector (Student Affairs);
- g) Cooking in rooms of PGH, except in pantries or kitchens;
- h) Lighting fire;

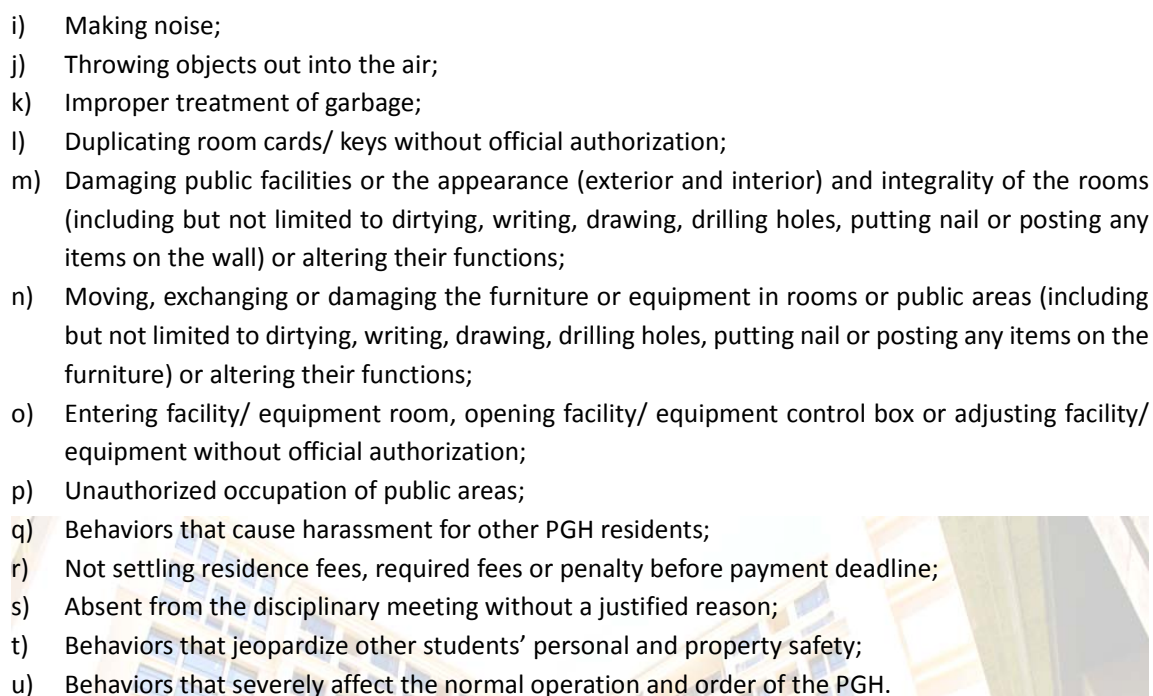
- 
- i) Making noise;
  - j) Throwing objects out into the air;
  - k) Improper treatment of garbage;
  - l) Duplicating room cards/ keys without official authorization;
  - m) Damaging public facilities or the appearance (exterior and interior) and integrity of the rooms (including but not limited to dirtying, writing, drawing, drilling holes, putting nail or posting any items on the wall) or altering their functions;
  - n) Moving, exchanging or damaging the furniture or equipment in rooms or public areas (including but not limited to dirtying, writing, drawing, drilling holes, putting nail or posting any items on the furniture) or altering their functions;
  - o) Entering facility/ equipment room, opening facility/ equipment control box or adjusting facility/ equipment without official authorization;
  - p) Unauthorized occupation of public areas;
  - q) Behaviors that cause harassment for other PGH residents;
  - r) Not settling residence fees, required fees or penalty before payment deadline;
  - s) Absent from the disciplinary meeting without a justified reason;
  - t) Behaviors that jeopardize other students' personal and property safety;
  - u) Behaviors that severely affect the normal operation and order of the PGH.

## Contact points

- **S1 Hostel Reception**

- Responsible for performing the S1 Hostel move-in/out procedures, access control and issuing room key card, housekeeping, maintenance and repairs.

**Office hours: 24-hour and 7-day operation (including public holidays)**

**Location: PGH – S1, G/F, Room G005**

**Contact number: 8822 2531, 6353 1156**

- **The Student Resources and Services Section – PGH Student Housing**

- Responsible for the application, allocation and arrangement of the PGH accommodation

**Office hours: Monday – Thursday, 9:00 am – 5:45 pm**

**Friday, 9:00 am – 5:30 pm**

**(Excluding public holidays)**

**Location: PGH - S3, G/F, Room G002**

**Contact number (office hour): 8822 8014, 8822 9911**

**Fax: 8822 2371**

**Email: [srs.hostel@umac.mo](mailto:srs.hostel@umac.mo)**

All the locations are shown in the “PGH Facilities Map”.

# Appendix

## The PGH Facilities Map (PGH-S1 ground floor)

Operating Hours of the entrance:

**Main Entrance:** 24 hours each day

**Restricted Entrance:** 9am to 11pm each day

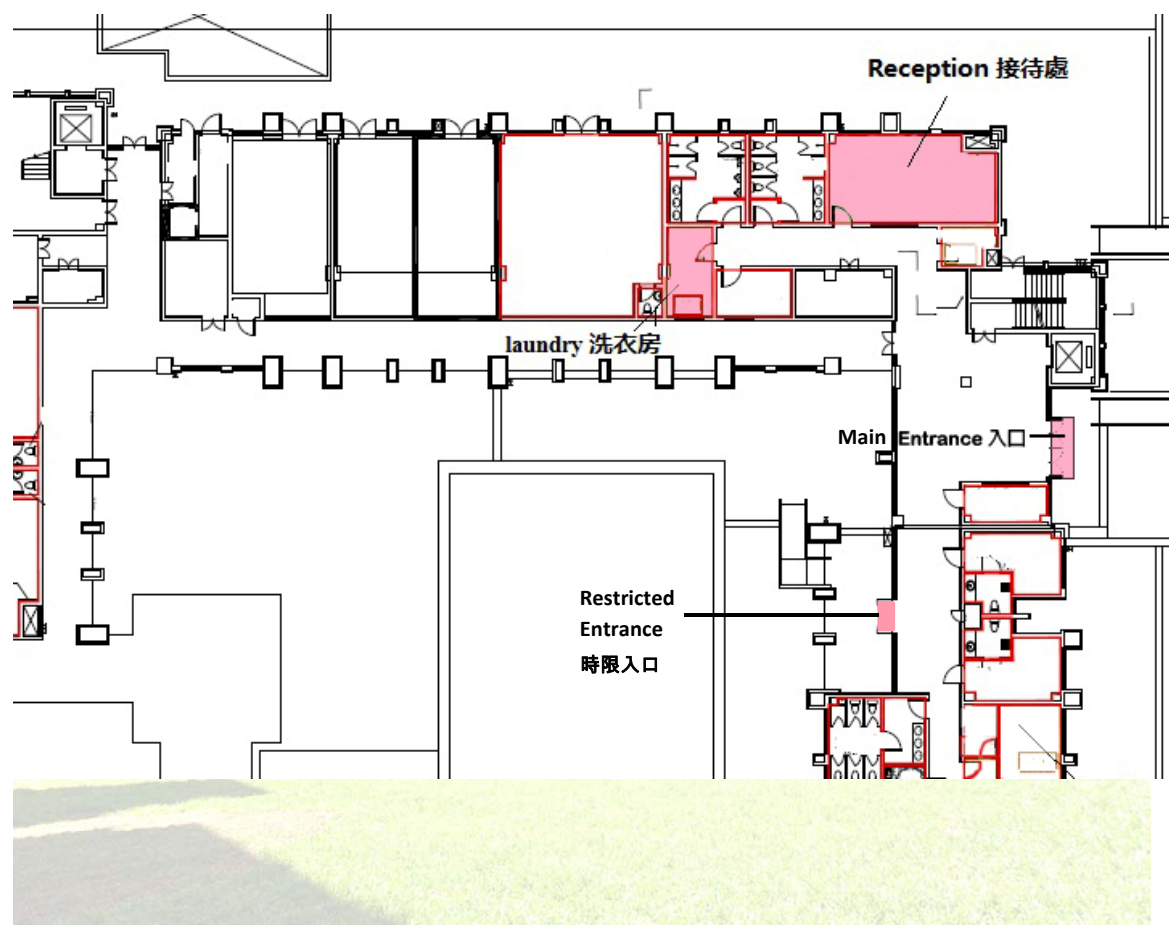



## The PGH Facilities Map (PGH-S1 Residential floor)



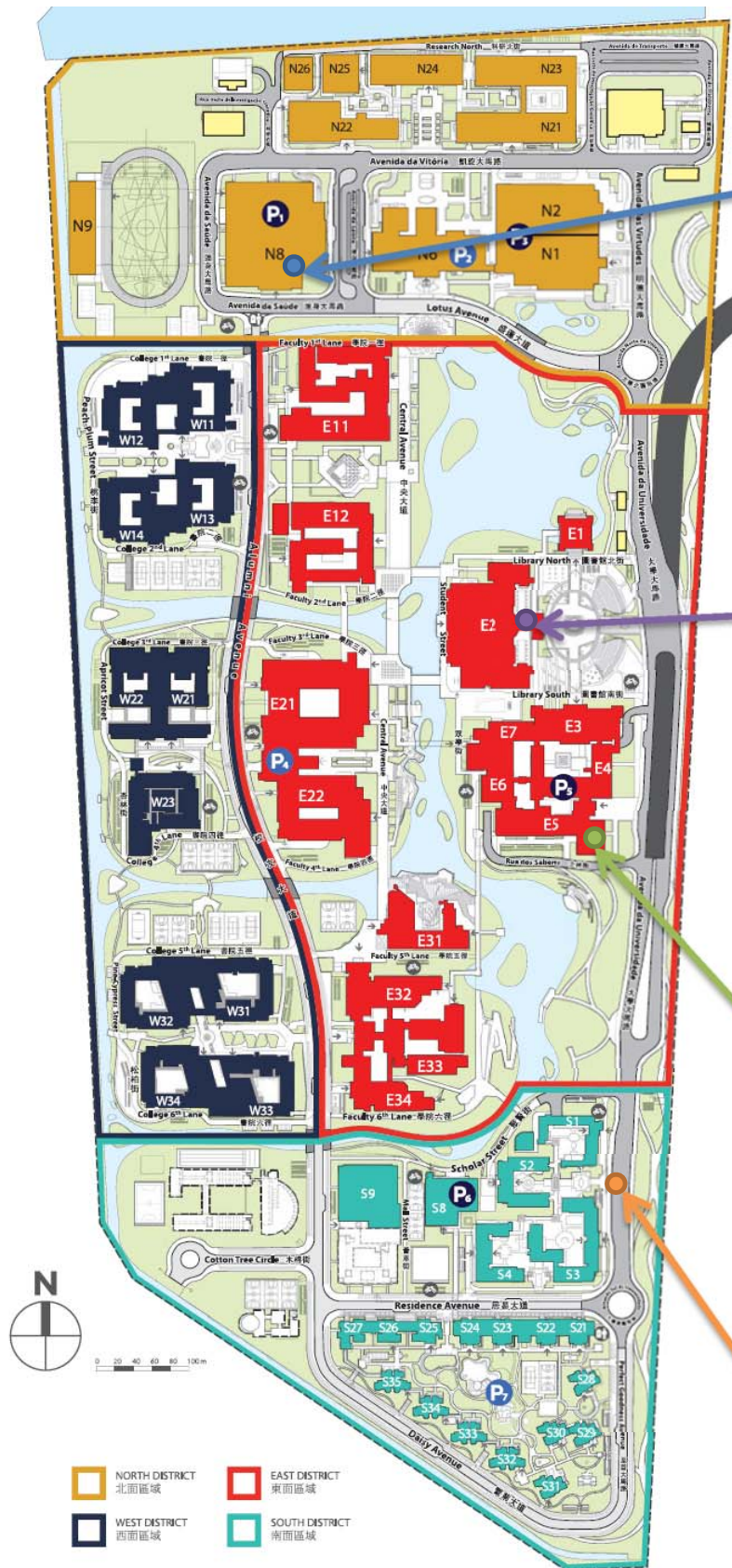

Medical Center of University of Macau  
澳門大學醫療中心



Pacific Coffee  
太平洋咖啡

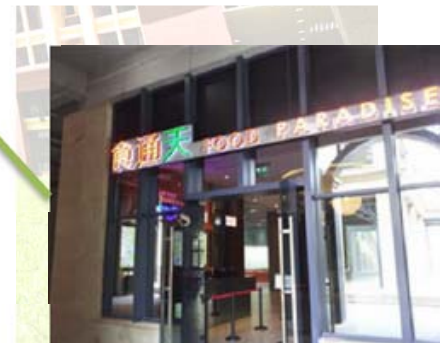

Canteen "Food Paradise"  
餐廳"食通天"



Public bus stop (37U, MT3U, 71 & 71X)  
公共巴士站 (37U, MT3U, 71 & 71X)